

□ = 1 ACRE

RYERSON LAKE NEWAYGO COUNTY, MICHIGAN 2024 PHOSLOCK TREATMENT MAP

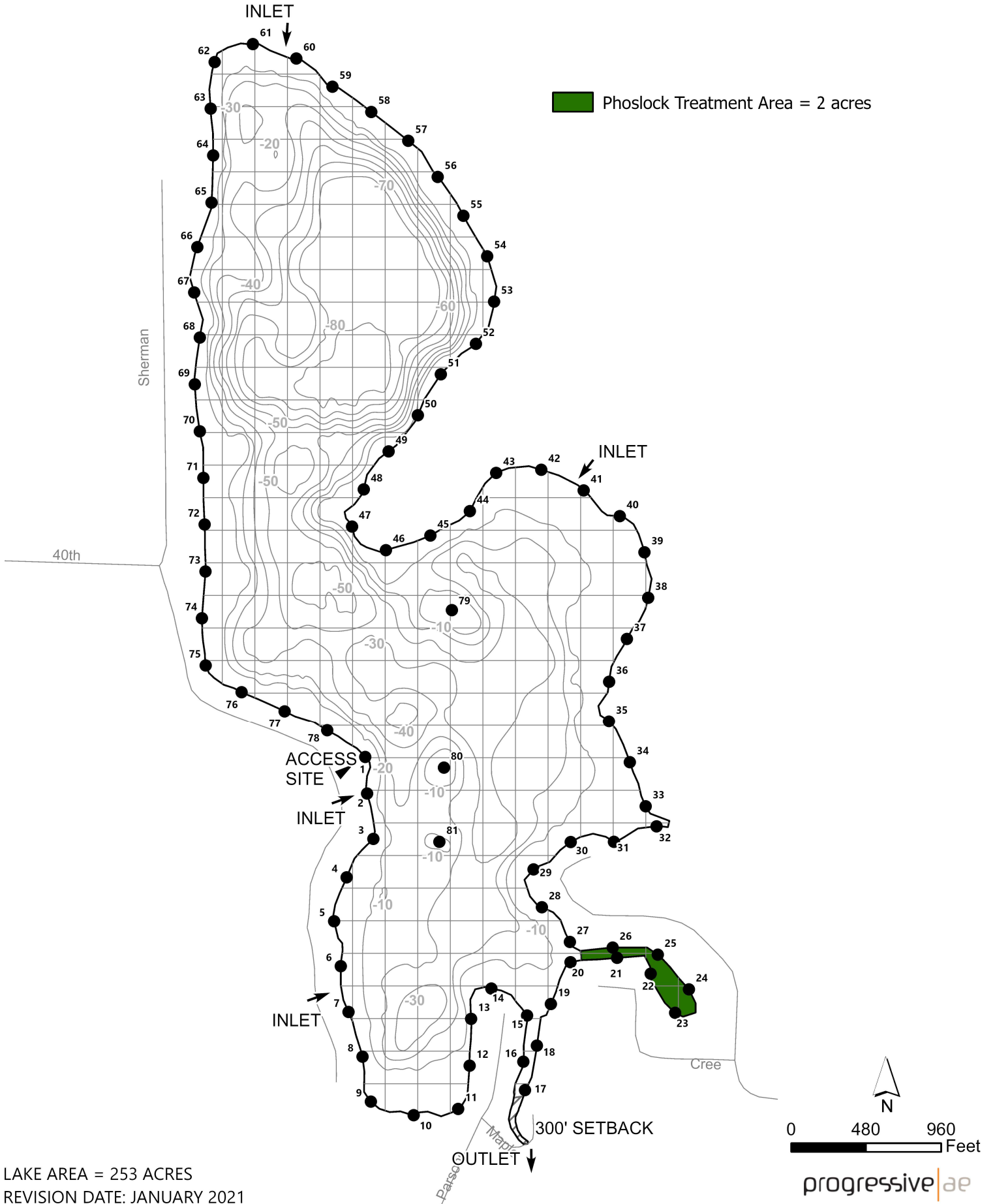

LAKE AREA = 253 ACRES
REVISION DATE: JANUARY 2021

progressive|ae

☐ = 1 ACRE

RYERSON LAKE NEWAYGO COUNTY, MICHIGAN TREATMENT MAP SURVEY DATE: MAY 20, 2024

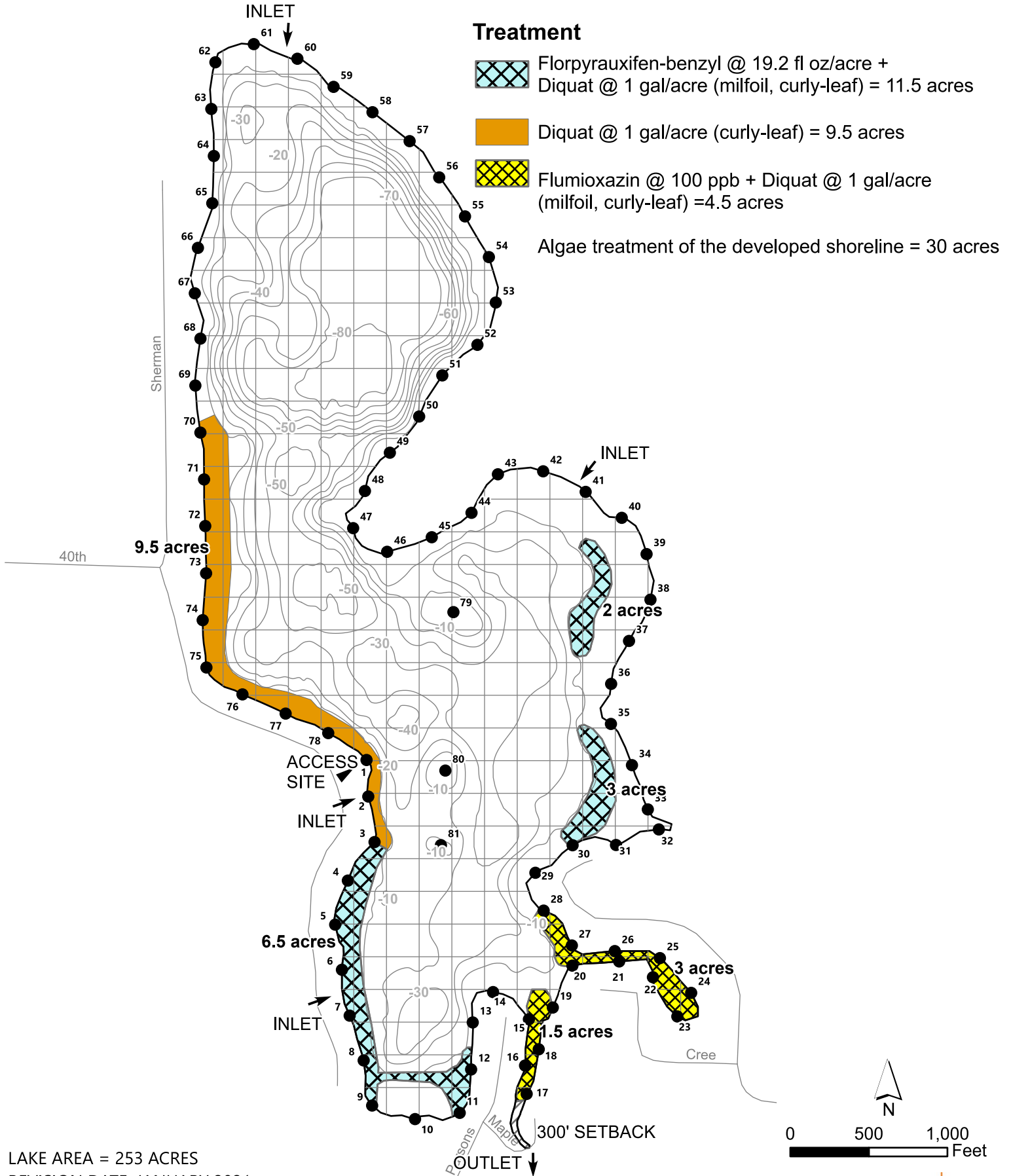

LAKE AREA = 253 ACRES

REVISION DATE: JANUARY 2021

The applicator shall make adjustments, if needed, to comply with EGLE permit requirements.

progressive|ae

□ = 1 ACRE

RYERSON LAKE NEWAYGO COUNTY, MICHIGAN TREATMENT MAP SURVEY DATE: JUNE 17, 2024

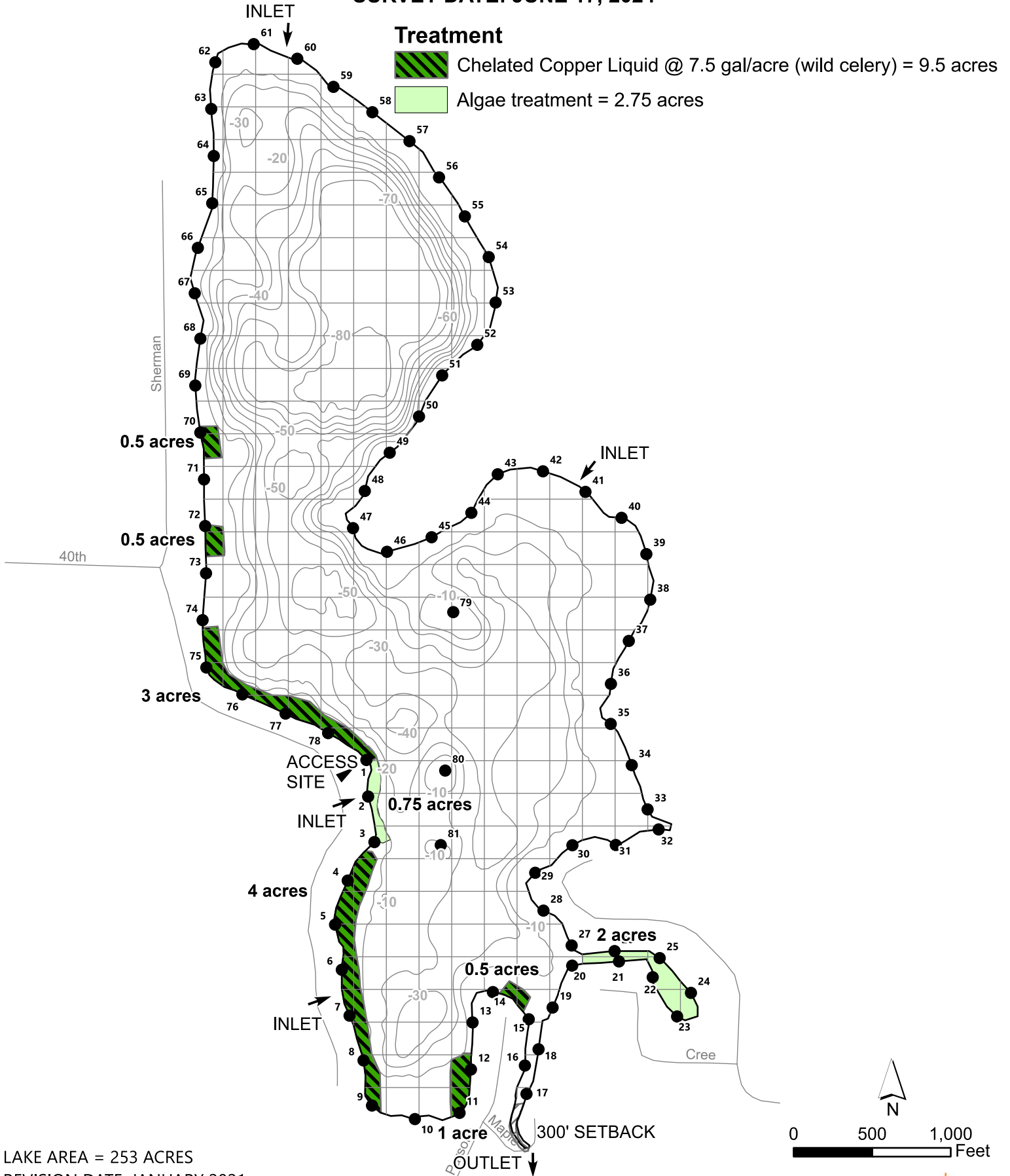

LAKE AREA = 253 ACRES
REVISION DATE: JANUARY 2021

The applicator shall make adjustments, if needed, to comply with EGLE permit requirements.

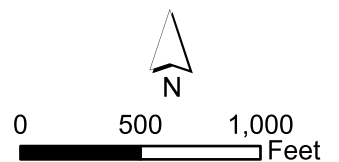

progressive|ae

□ = 1 ACRE

RYERSON LAKE NEWAYGO COUNTY, MICHIGAN TREATMENT MAP SURVEY DATE: JULY 23, 2024

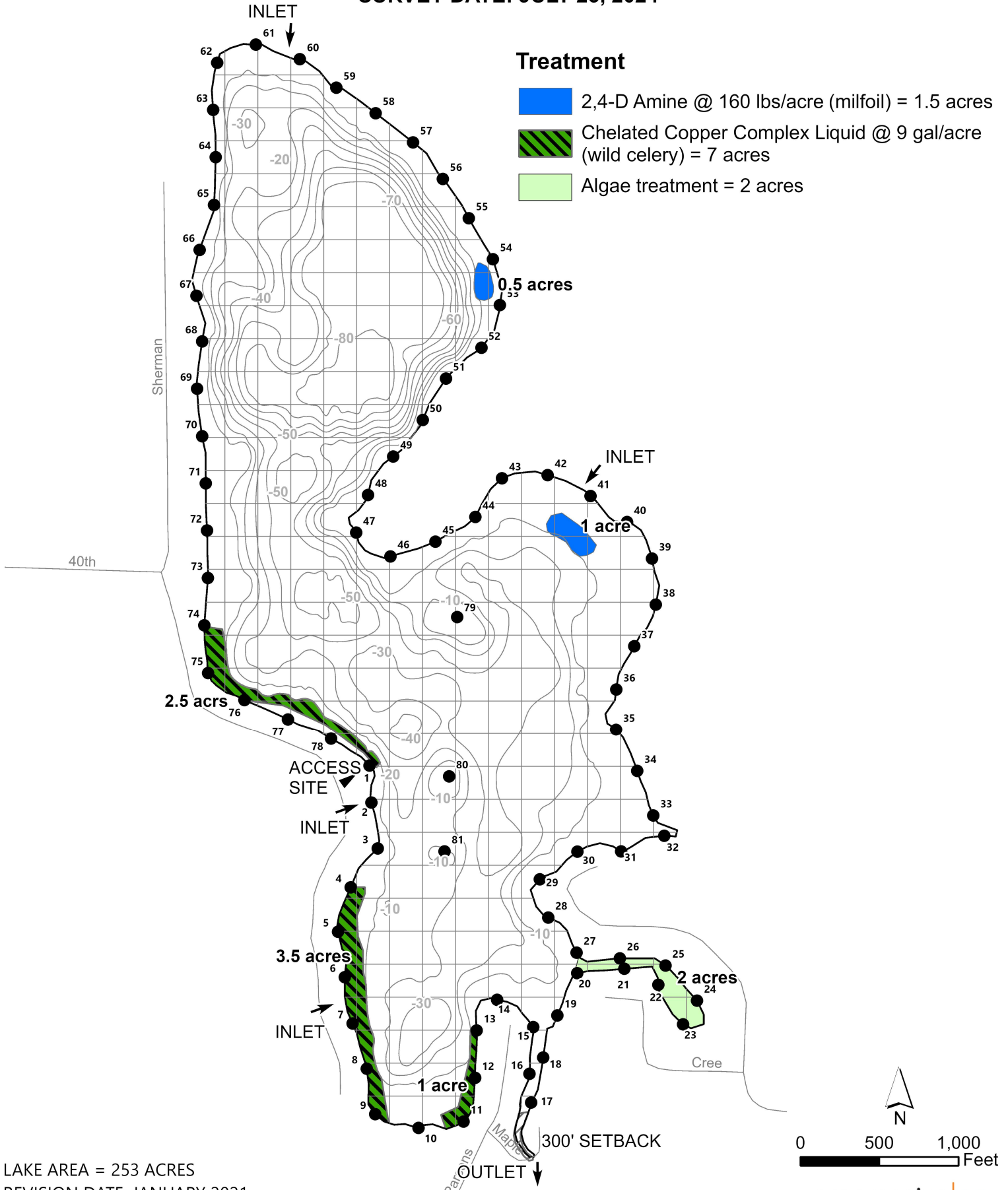

LAKE AREA = 253 ACRES

REVISION DATE: JANUARY 2021

The applicator shall make adjustments, if needed, to comply with EGLE permit requirements.

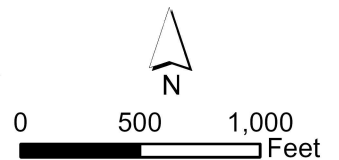

progressive|ae